

DESCRIPTION

The YC-822 is a indoor wall-mount box.

SPECIFICATIONS

|            |  |
|------------|--|
| Finish     | Surface-treated steel plate, off-white               |
| Dimensions | 124 (W) × 124 (H) × 61 (D) mm (4.88" × 4.88" × 2.4") |
| Weight     | 400 g (0.88 lb)                                      |
| Accessory  | Wall mounting screw ×4                               |

APPEARANCE

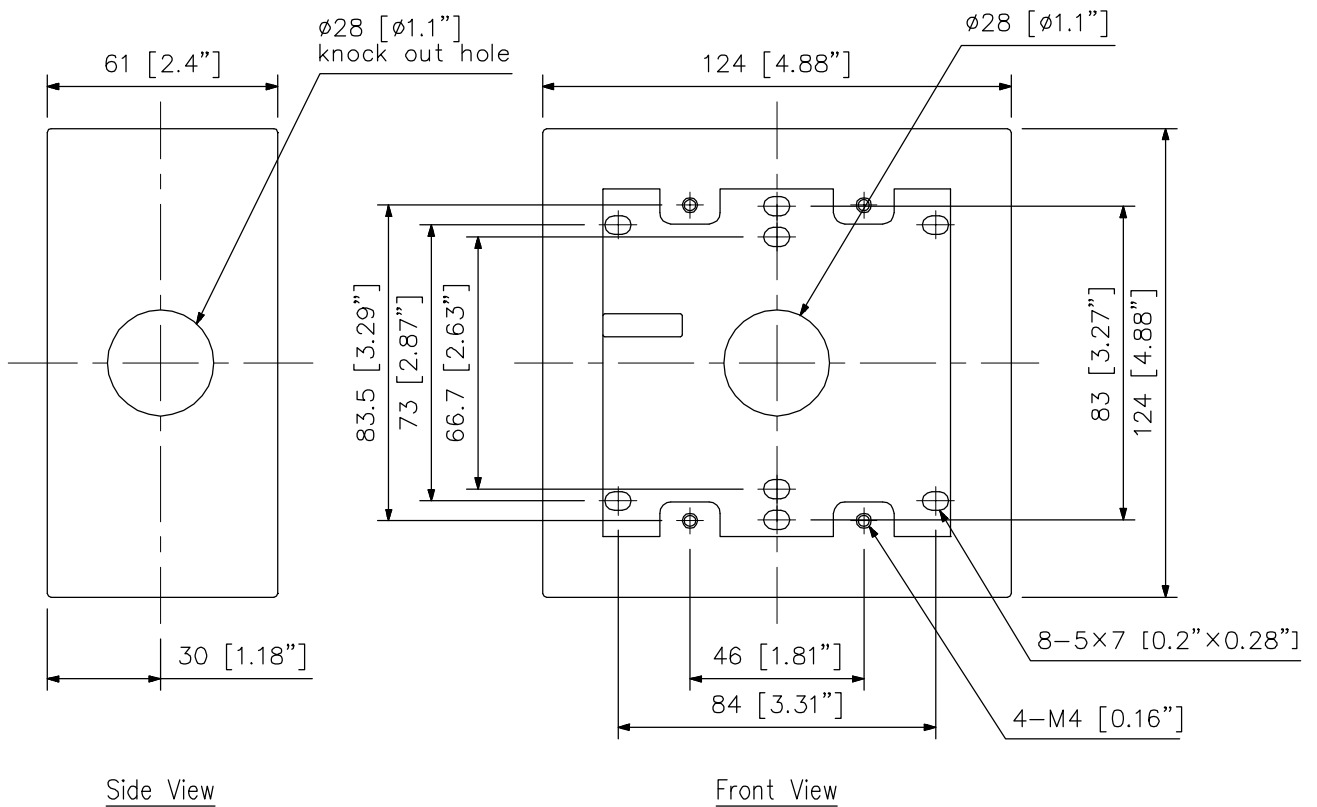

UNIT: mm SCALE: 1/2